



SERVING THE FOOD INDUSTRY SINCE 1951

36" Commercial Range with Burners, Griddle and Standard Oven – Natural Gas

ITEM: 46025
MODEL: CE-CN-0004-GN

46026
CE-CN-0002-GN



46025
CE-CN-0004-GN



46026
CE-CN-0002-GN

Multifunctional cooking in one. Maximize your cooking in your busy kitchen with Omcan's 36" Commercial Range with a combination of Burners, Griddle Plate and Standard Oven.

Equipped with open top burners, this natural gas range provides the power needed to sauté, boil, and simmer your dishes flawlessly. The standard oven offers extra flexibility, allowing you to warm foods or bake desserts. With a temperature range from 121° to 288° Celsius, it can handle a diverse range of recipes.

FEATURES:

- ✓ Stainless steel front with welded frame for stability
- ✓ 6" stainless steel adjustable heavy duty legs
- ✓ Two / Four open top burners, each 30,000 BTU/hr
- ✓ Covered pilot burner cover to prevent clogging from spillage
- ✓ Stainless steel pilot for durability
- ✓ Heavy duty cast grates for each burner, 12" x 12" (300 x 300 mm) in size, easy to removed
- ✓ 31,000 BTU/hr. U-shape burner for each bottom oven
- ✓ With 20000 BTU/hr burner (1 pc / 2 pc) for griddle
- ✓ Full size sheet pans fit side-to-side or front-to-back
- ✓ Oven thermostat adjusts from 121° - 287.8°C (250°F to 550°F)
- ✓ Two oven racks and four rack positions
- ✓ 3/4" Griddle plate thickness

Telephone: 1-800-465-0234

Fax: (905) 607-0234

Email: sales@omcan.com

Website: www.omcan.com



Authorized Dealer



TECHNICAL SPECIFICATION

Item	46025
Model	CE-CN-0004-GN
Gas Type	Natural Gas
Number of Burners	4 Burners
Burner Dimensions (WD)	12" x 12" (304 x 304 mm)
Griddle Plate Dimensions (WD)	12" x 24" (300 x 602 mm)
Thickness of Griddle Plate	0.75" (19mm)
Oven Dimensions	26.6" x 23.5" x 13.9" (675.6 x 596.9 x 353 mm)
BTU	171,000 Burner: 30,000 (each) Griddle Burner: 20,000 Oven: 31,000
Temperature Range	121 - 288°C (250 - 550°F)
Net Dimensions	36" x 32.5" x 60" (914.4 x 825.5 x 1524 mm)
Net Weight	238 lbs. (108 kg)
Gross Dimensions	41" x 40" x 52" (1041.4 x 1016 x 1320.8 mm)
Gross Weight	458 lbs. (208 kg)

TECHNICAL DRAWINGS

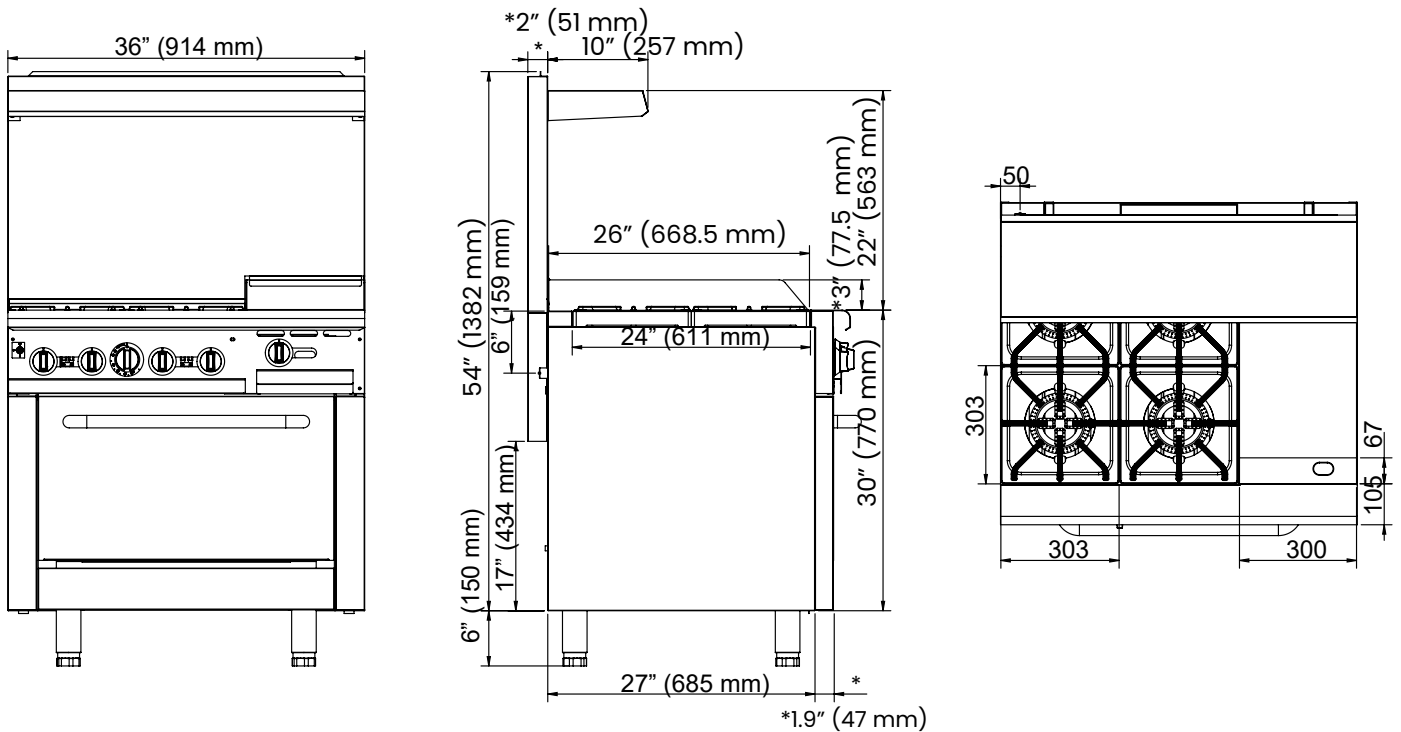

Dimensions rounded up to the nearest inch or millimeter. Specifications subject to change without notice.

TECHNICAL SPECIFICATION

Item	46026
Model	CE-CN-0002-GN
Gas Type	Natural Gas
Number of Burners	2 Burners
Burner Dimensions (WD)	12" x 12" (304 x 304 mm)
Griddle Plate Dimensions (WD)	20" x 24" (508 x 602 mm)
Thickness of Griddle Plate	0.75" (19mm)
Oven Dimensions	26.6" x 23.5" x 13.9" (675.6 x 596.9 x 353 mm)
BTU	171,000 Burner: 30,000 (each) Griddle Burner: 20,000 Oven: 31,000
Oven Temperature Range	121 - 288°C (250 - 550°F)
Net Dimensions	36" x 32.5" x 60" (914.4 x 825.5 x 1524 mm)
Net Weight	403 lbs. (182.8 kg)
Gross Dimensions	41" x 40" x 52" (1041.4 x 1016 x 1320.8 mm)
Gross Weight	507 lbs. (230 kg)

TECHNICAL DRAWINGS

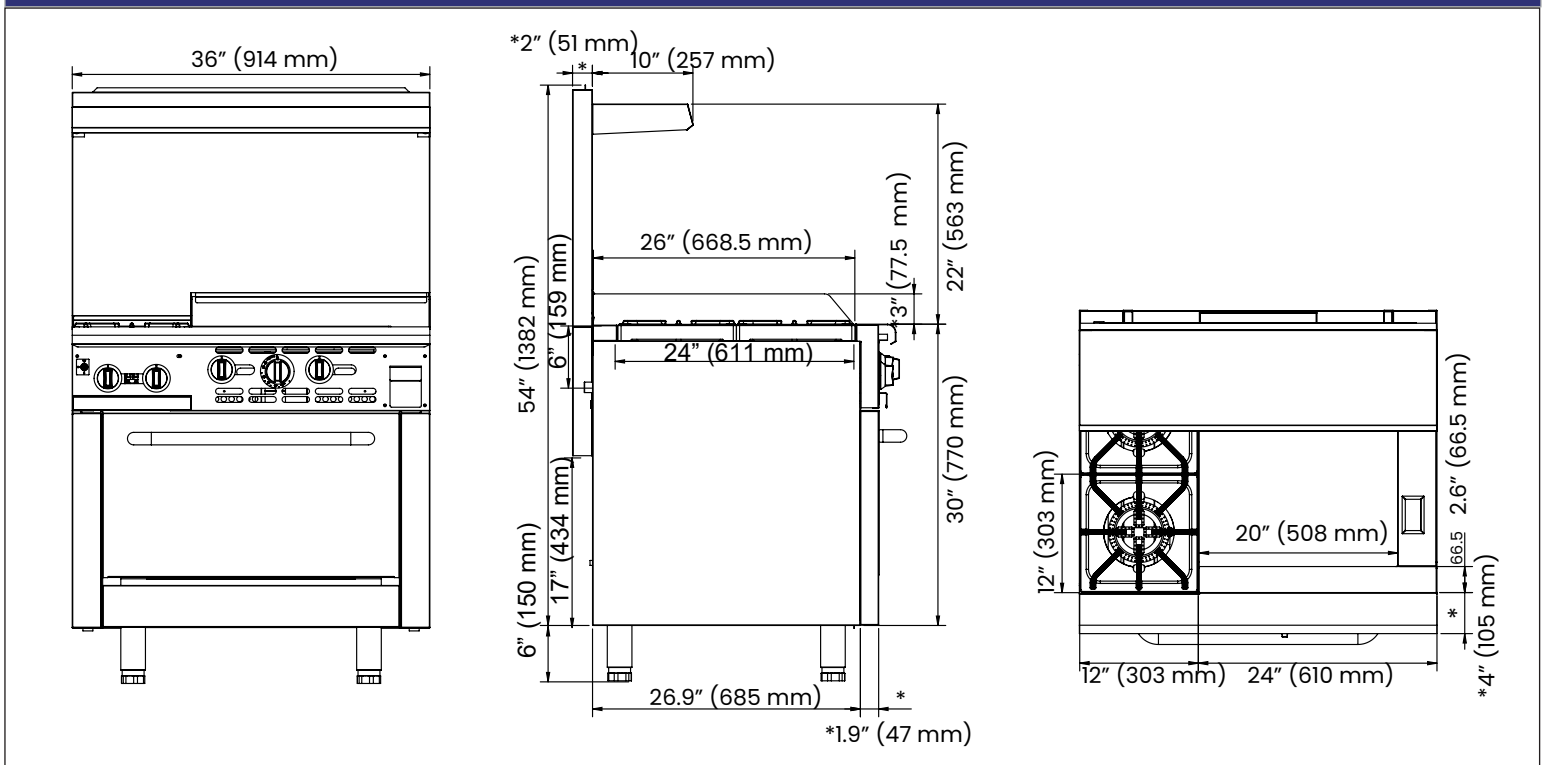

Dimensions rounded up to the nearest inch or millimeter. Specifications subject to change without notice.